

WHITNEY UNITED METHODIST CHURCH

W
H
I
T
N
E
Y

Rev. Christina Thompson, Pastor

Worship with us every Sunday at 10:00 a.m.

3315 Overland Rd. Boise, Idaho

SEPTEMBER 2019

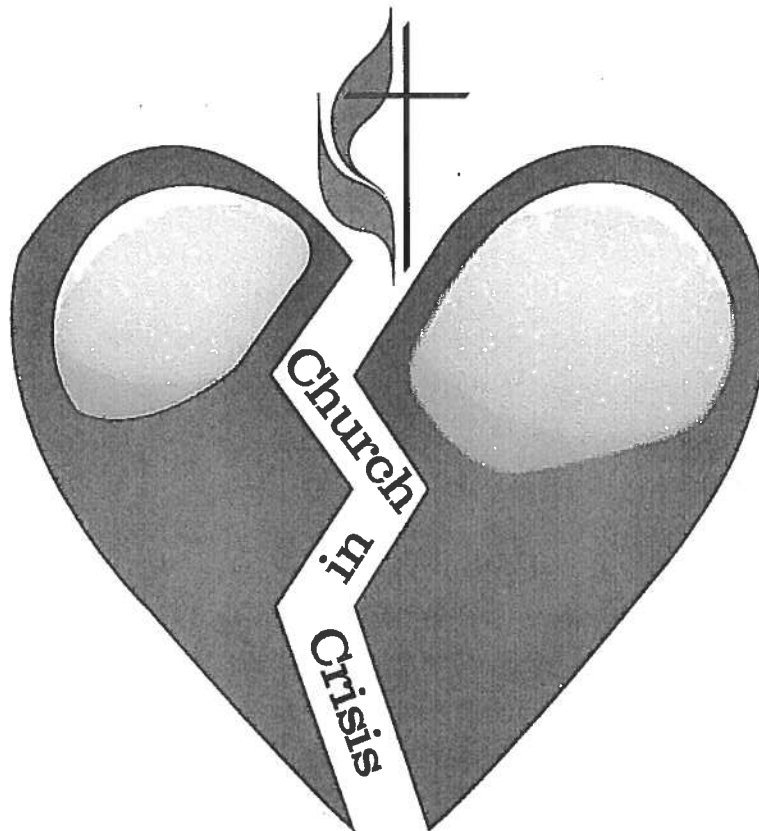

"Church in Crisis!" is an informational course about the difficult choices facing United Methodist and their local churches. The course begins September 15 and runs for nine classes through December 1.

More information inside.

Contact us:

Phone — 208-343-2892

Email — 3315whitneychurch@gmail.com

website — www.whitneyumc.org

Facebook — Whitney United Methodist Church

OPPORTUNITIES

Sunday

Worship 10:00 a.m.

9:30 am Adult Sunday

School

8:30 am Adult Bible Study

Children's Sunday School

10:20 m

Nursery 9:30 am

Monday

1st & 3rd Mondays

6:30 pm Stephen Ministry

2nd & 4th Mondays

6:30 pm Shawlers

Third Monday

10:00 am Congregational

Care 10:00 am

1st Wednesday

12:00 noon UMW

Wednesday

1:30 pm Prayer and Share
small group

7:00 pm Chancel Choir

Thursday

5:45 pm 6 Ways to
Sunday Praise Band

3rd Friday

WEPRAY team.

6:00 pm Community
dinner

2nd Saturday

9:00 am UMM

Every Saturday

10:00 am Saturday Lunch



From our pastor.....

“The first Sunday school room at Whitney United Methodist Church was in the living room of a house on the corner of Overland and Gurley Street in 1941. Mrs. Harry Strong was appointed to act as the Sunday School Superintendent and to organize a Bible Study class. She moved to Arkansas to join her husband called into active duty. So Mrs. Henry Matlock (Iva) was appointed General Superintendent of the Sunday School in 1942 and Mrs. Fred J. Allen (Jessie) was appointed Superintendent of the beginners department. As good news of a Sunday School on the Whitney Bench was spread, people began to send their children. The church school grew so rapidly that it was decided to enlarge the cottage and an addition was built. But even this addition was not enough and a new church building was deemed essential.

Dr. Charles Donaldson was appointed to Whitney in 1946 and assigned to take charge of the development of a religious center on the Whitney Bench. At the time that he took over as Pastor, there was no church building, few means to finance the enterprise and only a few members (36) to carry the load.

And yet, a new church sanctuary was built and opened in 1948 and God’s hand was apparent in every phase of the building. Memorial gifts, gifts from leading firms in the city, and small gifts from the children all helped in the completion of the enterprise. Many people gave to make it possible for the church to be built. It is hoped that this spirit will brighten our years to come and the generations that follow.”

This history of the beginning of Whitney United Methodist church is from “Whitney United Methodist Church First 50 Years” written by Dorothy J. Borger (a member of Whitney UMC who died a few years ago.)

I love her telling of this story of where the church came from. This church felt a call to reach the children and families of our neighborhood even though there were not a lot of church members or a lot of money to do so. But there was a sense that God was calling them to reach these children and families and they trusted God’s hand to help it happen.

It is 78 years since that first call on this church to reach children and families and God is still calling us to share God’s love and grace with the children and families in our neighborhood.

And we are facing the same challenge those 36 church members faced--- lack of space. While we have a church building, we are rapidly running out of room. The Sunday school room we have for the kids is not big enough for the kids we have and certainly does not have room for growth. The adult Sunday school class has outgrown it’s room. On most Sundays, the parking lot is full and even the Sanctuary does not have too much more room for growth.

In order to reach new children and families as we feel God is calling us, we need to have the space for them to feel like there is room for them.

So in this last year, the church council and the finance team have been studying our space needs, the potential for growth and the needs of our community. Through this study, it has been clear that we, as a church, need to make plans for the future. These plans need to include a short term solution as well as long term dreams.

So we have been working on just that. A group of church folk met this spring to brainstorm some short term solutions. We had an all church meeting on June 23 to present the needs to the congregation. We have procured the work of Rev. Larry Abell who is an architect in our Annual Conference who works with churches. And on August 18, we had a church conference where we voted to “consider a building or remodeling project at Whitney UMC to address our lack of space as outlined by the study committee.”

We also approved a building committee to pursue this project. That committee includes Bert Allen, Shelley Cooper, Malcom Dunten, Miriam Fridel, and Gena Waller. There is room for another person or two on this committee so if you feel God calling you to be a part of this committee—please see Rev. Christina.

But we do recognize that a remodeling or building project does take funds to make it happen. So we have also established a Stewardship Ministry Team to look at ways to raise the funds for what God is calling us to do. This Team includes Nick Alexander, Shelley Cooper, David Hawk, Maran O’Meara, Ramona Walhof, Gena Waller and Rev. Christina.

I can only imagine what those 36 original members of this church were thinking when they took steps of faith to build a building. There had to be a lot of doubt—“There are not enough of us. We can’t afford this? Will it work? What if it fails?” And yet, I can also hear their words of faith “God is a God of abundance. There is enough to make this happen. What great dreams is God calling us to?”

I have similar doubts and similar words of faith. I know that the God who called this church to reach out to children and families in the unknown years of WWII, is still the God who is calling us to continue that mission today. And I know that the hand of God that was apparent in every phase of the first building of this church, is still very much apparent in what is happening here at Whitney UMC now. I have no idea exactly what this building project will end up looking like, although I do promise that we will be fiscally responsible in building. But I do know that God is actively at work and when this project is all over, we will be amazed at what God did through us. And I know that Iva Matlock, Jessie Allen and Mrs. Harry Strong, and all of the rest of the original 36 members of this church are cheering us on.

Blessings,

Rev. Christina

Minutes from the Whitney UMC All Church Conference

August 18, 2019

Moderator: Rev. Jane Shaffer. There were 40 members attending.

Rev. Christina stated that the purpose of the meeting was that over the last couple of years it has become clear that the church is outgrowing its available space particularly in the classroom and storage areas. The Finance Committee recognized the need and commissioned a study committee who did an analysis of those needs. They determined it was time to begin looking at doing something either by remodeling existing space and/or building a new building.

Question #1 – ORIGINAL MOTION: *Motion to authorize a building/remodeling project at Whitney UMC to address our lack of space as outlined by the study committee.*

Motion made: Rev. Christina Thompson, **Seconded by:** Bert Allen.

Call to amend original motion: Carla Biersdorff

AMENDED MOTION: *Motion to **consider** a building or remodeling project at Whitney UMC to address our lack of space as outlined by the study committee.*

Amended motion seconded: Dave Hawks. **Amended motion carried**

Question #2 – We elect a building committee to serve in the development of this project.

a. Shelly Cooper b. Malcom Dunten c. Gena Waller d. Miriam Fridel – youth rep e. Bert Allen.

Motion carried

The building committee is tasked to use information from the study committee and all relevant info made available; to estimate carefully the building facilities needed; to develop a preliminary architectural plan that includes city and building codes; to develop a financial plan that includes all estimated costs of the project, the projected funding from church members and other sources and the amount to be financed and to work in conjunction with the stewardship Committee in securing those funds.

The Stewardship Ministry Team members: (This did not require a vote)

Ramona Walhof, Gena Waller, David Hawk, Maran O'Meara, Shelley Cooper, Rev. Christina Thompson.

It was suggested that the Council make available the results and standings of the commitments made under the Vision and Mission statement developed four years ago in terms of attendance, in terms of need and other things. That people are more willing to financially support the project if the church can show that goals have been achieved and that the church is continuing to move forward.

Rev. Jane closed the meeting by encouraging each member to listen carefully to where God is calling them and to listen carefully to God's guidance thru others.

UNITED METHODIST WOMEN



The first meeting of the fall for United Methodist Women will be on September 4, 2019 at noon with a potluck lunch. All women of the church are invited to attend. In addition to our business meeting where we will determine our mission giving for 2020, Carla Biersdorff will be sharing her photos and stories of her 3 months in Scotland this past year and there will be an informational meeting concerning the Craft Fair.

The Sage District UMW annual meeting will be in Kimberly on Sept. 28 from 9:30 a.m. to 3:00 p.m. The theme is maternal and child health care and will feature a speaker from Twin Falls who will speak about the importance of proper health care for women. We will also have a speaker from Protect Idaho Kids who will speak on supporting legislation that will prevent religious exemptions for medical care for children and an update on other legislation concerning women and children. We will be installing officers for the coming year. Two Whitney women will be district officers – Gena Waller – Communications and Lory Nesor will continue on the Nominating Committee. Our day always concludes with worship and communion. You are all invited and we hope to have at least one car of women going. If interested, see Lory Nesor for details.

Our vision: Turning faith, hope and love into action on behalf of women, children and youth around the world.

* * * * *

CALLING ALL KNITTERS, QUILTERS, FLEECE BLANKET MAKERS, CROCHETERS!

The Oregon-Idaho Conference of United Methodist Women is joining the Pacific Northwest and Alaska Conferences United Methodist Women in a project to make quilts for “Children at Risk.” The goal for our conference is 160, 40 from each district (but we are really hoping for 400!)

All the quilts will be taken to the combined Annual Conference on June 11-14, 2020 in Puyallup, WA. The quilts will then be divided among the districts for distribution to agencies benefiting/working with children.

The blankets can be **quilted, knitted, crocheted or made (tied) from fleece.**

Suggested dimensions for the finished quilts are:

45" x 45"

45" x 60"

or 56" x 84" for a twin bed

There will be more information later and we will collect them through our local Whitney unit to be taken to Annual Conference. Let Lory Nesor know if you think you would like to participate in this project.

Lory Nesor's contact information: Lneser@aol.com; 808-286-4829



Glenna and Jake Finley **Long time members of Whitney**

Glenna Finley has been active at Whitney Church since 1958. She taught Sunday school while her sons, John, Jim and Jerry, were growing up. Then she served as President of United Methodist Women for nearly thirty years. In that capacity, it was part of her responsibility to visit all the shut-in members of the church, a big job. She said, "It seems that many things were different then."

Glenna commented, "I love to decorate things and did that for many activities." She still decorates for UMW.

Glenna grew up in Boise and graduated from Boise High School. She worked for Kress Dime Store downtown for about 7 years. Then she and her first husband, Bill Wray, owned and managed a commercial laundry and dry cleaning company on Broadway until Bill became too ill to continue. He passed away in 1981. Glenna became activity Director for Capital Care Nursing Home.

A neighbor introduced Glenna and Jake Finley, and they were married December 5, 1992. They took their honeymoon for a month in Europe, and Glenna retired.

Jake grew up in La Grande OR. After high school, he joined the Navy and was sent to Korea. He and his first wife had a son and a daughter, Jeff and Melissa, and Jake has 5 grandchildren. One of his granddaughters Chennell is now a sophomore at BSU and keeps in close touch with her grandpa and Glenna. She lived with them during her senior year of high school.

Jake worked as a machinist in La Grande and on the maintenance crew for state buildings in Idaho. He helped with Boy Scouts at Lowell Grade school and at Whitney Church. He was a long-time member of the Methodist men when it was a large group, and he helped with Friday night dinners. Jake also worked with the Disabled American Veterans (DAV) and served as President for some time.

Before I asked Jake any questions, he said, "I love the church, and I love God. I want to help where ever I can."

Glenna has a son in Utah, and a grandson in Hawaii. Her youngest son, Jerry and his wife, live in Ecuador and are active with the Jehovah's Witnesses. He calls his mother at least once a week. Her oldest son John and his son William live in Boise and are a lot of help to the Finleys now. William has 8 children. Glenna says "They're all different, and you just hear more from some than others."

Glenna says it is harder now to get around, but they are looking forward to tuning in to the Whitney Sunday morning services on the radio.



- 1 Mel Slocum
- 3 Johnna Dunten
Jeff Higgins
- 6 Jody Baer
Kelly McGrath
Gena Waller
- 4 Nick Alexander
- 8 Rhonna Dunten-
Schachter
- 11 Kacey Larracochea
- 12 Neil Buttram
Duane Campbell
- 15 Bonnie Hawk
Sharon Miller
- 17 Bill Slupe
Eric Tabb
- 18 Jake Finley
- 20 David Hawk
- 21 James Christophel
- 22 John Owen
Evelyn Thompson
- 25 Zena Larracochea
- 26 Brinley Christophel
- 28 Dale Thompson
- 29 Joseph Shelby
Michael Waller

IN OUR PRAYERS

Carl Harden, Stan Herzinger, Glenna Finley, Sally Cupan, Dale Thompson

SHUT-INS TO PRAY FOR THIS WEEK

Dortha Bixler, Glenna Finley, Don Halsey

INCESSANT PRAYERS

Cheri Carter, Ruthie Carter Ruthie's Grandson, Carter, Richard Miller, Bonnie Hawk, Marvin Wolfe and family, Val Vittori, Sue Frear, Dale and Evelyn Thompson, Marlys Tudehope, Keith Gillespie, Johnna Dunten, Malcom Dunten, Jake Finley, The Family of Billie Lirgg, The Family of Ron Jordan

MILITARY PRAYERS

David L. Hawk, Mark Jerome

STUDENTS IN SCHOOLS OF HIGHER LEARNING

Jenneth McNeas-Ayodele, Justine Niyogushimwa, Marissa Jerome, Nicole Jerome, Nick Nesor, Braeden Dunten, Spencer Jordan, Jordyn Walhof, Hayli Ball, Hannah Ball, Christopher Kozama, Masson Furitami

MANNA *(meet 4th Sundays)*

resumes September 22 at 5 pm.

Attending the "Church in Crisis"

class is not a prerequisite as MANNA is a time for anyone in the church to gather for a potluck dinner and fellowship. Just bring your favorite dish to share and it helps with the clean- up if you also bring your own table setting.

For information call Cathie Slocum 887-0986



Wedding Anniversary

**Ann and David McQuade
Evelyn and Dale Thompson**

Remember the disinfectant wipes for Whitney Elementary School. They need them for the entire year so you may bring them to the church office at any time.

SEPTEMBER HOSPITALITY

Date	Liturgist	Greeters	Coffee Hosts	Communion Stewards
September 1	Becky Platt	Kathy Skalsky	Dottie Harden Julie Hall	Kim & Stewart Gardner Clint Wachi
September 8	Glenda Berto	Brad Miniasin Robert Burge	Lori Baer Gaye Cabe	
September 15	Carla Biersdorff	Julie Hall, Kathy Hammers, DeDe Matthews	Arny & Kathy Skov Gordy & Jody Myre	
September 22	David Hawk	Gordy & Jody Myre	Betty Dippi	
September 29	Johnna Dunten	Elvin Clubb Ruthi Carter	Julie Hall	

CRAFT FAIR

The time is approaching!!! November 1st and 2nd!!!

**There will be a meeting after the UMW meeting on Wednesday, Sept. 4th.
Please plan to attend, whether you are making items to bring or are a
helper in some way.**

Your opinion is needed in several areas such as:

the Friday supper

Grandma's attic

name determination

pie/cake for lunch and sale

homemade and handmade items

pricing

other ideas you may have

silent auction

We are looking for items which can be used for our Silent Auction table at the Craft Fair. These are usually specialty items which can be bid on. In the past we have had paintings, quilts, dolls/doll clothes, specialty baskets such as – kitchen items, a movie basket with passes/popcorn etc., spa items, This year we are asking the person who donates to place a minimum bid for the item and if that bid is not met, the item will be returned to that person. What are your special skills, gifts that others can use and enjoy? For more information see Lory Neser (808-286-4829)

There are sign up sheets on the bulletin board in the hallway where you can indicate your favorite place to help.

Ideas and help for projects are also available and a work day is planned for September.

Co-chairperson, Lorrie Baer, has more info if you need it.





IN REMEMBRANCE

Willimae "Billie" Lirgg

Willimae "Billie" Lirgg passed peacefully in her sleep at her home in Brookdale Community Living Center in Boise, Idaho, on July 17, 2019 at the age of 87.

Billie was born on August 6, 1931 to Charles and Margaret Warren. She is survived by her three children, David Lirgg, Christine Ward, and Patty Hamilton; she was blessed with 6 grandchildren, and 10 great-grandchildren.

Billie was married to her high school sweetheart, Burrell G. Lirgg, on July 22, 1950; they enjoyed 64 years of marriage. Burrell passed on August 21, 2014.

Billie attended nursing school in Oakland, CA. In 1951 she met up with her husband in Connecticut when he retired from the Navy. They moved to Idaho in 1952 when Burrell accepted a position with Idaho Power. They lived at various power plants until moving to Boise in 1963 where Billie pursued her career as a nurse, retiring in 1990.

In 1973 Billie and Burrell designed and built a beautiful log cabin in Round Valley, Idaho where they hosted friends from all around! There they enjoyed nature, and even built the first zip line!

Billie loved to read, travel, garden, create stain glass windows, refinish antique furniture, and so much more.

As anyone who knew Billie is aware, family and friends were the highlight of her life. From providing home-made meals for her growing family to hosting large gatherings for holidays, their home was filled with love and laughter.

The family would like to thank all the care takers that were with her in her final days. She was surrounded by love and laughter until the end.

Although Billie is no longer with us, we can all take comfort in knowing she passed peacefully, knowing she was loved, and is now reunited with her husband and all those loved and lost, including her beloved dogs Katie and Bandit.

Billie's passion in life was to give more than she received; to be honorable in all things large and small. She was a rock countless people relied on her entire life. She touched many lives and will be sorely missed, always loved, and never forgotten.

A celebration of life was held August 24, 2019, 2:00 PM at Whitney United Methodist Church.

It was Billie's wish that in lieu of flowers, please donate to the Idaho Humane Society, or Channel 4 Public TV.

For your Reflection
CrossOver reflection for Week 37 *We Make the Road by Walking*, Chapter 50
Rev. Deena Wolfe

My heart sank when I heard those words. My dad had been declining for two years, but I was not ready for the reality of what those words meant. I felt both fear and sadness, and I knew that his days on this earth were short. I was preparing to begin work as a hospice chaplain, and over the next 3 ½ weeks, orientation became personal.

“It’s time to consider hospice.” For ten days we sat in vigil for him, and a little over four years ago he stepped off this earth and into glory. It was a beautiful and very emotional time as we went from brief moments of conversation together to him slipping into a coma and then taking his last breath.

This experience has enriched my ministry as a grief counselor and hospice chaplain with deep empathy for those who hear the word “hospice.” The reality of death is now staring you in the face. Our culture does not give fertile ground to the discussion of life and death and the grief that comes along with it.

Everything in this world is moving from birth to death. People die, relationships end, corporations go out of business, churches close. How do we move from a place of paralyzing fear to embracing the possibilities that come with the death of something or someone we love?

As people, it is natural to feel fear of the unknown. When my dad was dying, he suddenly opened his eyes wide and said, “Wow.... mom’s going to be shocked!” He saw something on the other side which we couldn’t see, something which was amazing and beautiful. He was unable to share with us what he was seeing, but the joy and wonder on his face were unmistakable. They brought great comfort as we mourned this time of separation. The picture above was taken by my brother, the evening before dad died. For us, this was dad’s angel, coming to guide him home.

In this week’s chapter of *We Make the Road By Walking*, Brian McLaren writes: “As we walk this road, we not only remember the past, we also anticipate the future, which is described as a great banquet around God’s table of joy. When you pass from this life, do not be afraid. You will not pass into death. You will pass through death into a greater aliveness still – the banquet of God. Trust God, and live.”

This principle applies to relationships with the people that we love but also has great meaning with all the uncertainties we see in the church today. For there to be new life, death must occur. God is with us in every part of our lives, from celebrating the birth of a new life, or a new ministry, to mourning with us in the pain and sorrow that occurs when a ministry ends, or someone dies.

We are invited to embrace “hospice” moments in our everyday lives. Hospice provides supportive relationships, individuals walking together, shepherding the person and their family members on the road from life to death. We trust that the Spirit who brings us life will lead and guide us through these times of uncertainty into a place of deeper relationship.

Part of our Wesleyan heritage is the value of the experiences we have in our lives. Whether an experience is filled with joy or sorrow, or birth or death, there is something valuable to be gained, a piece of wisdom to be pondered for use later. May we take great comfort that our triune God—Creator, Christ, Comforter is living and active in our lives—from before birth to after death.

Rev. Deena Wolfe serves as pastor for Valley-Veneta United Methodist Church in the Oregon Idaho Conference as well as a Hospice Chaplain for Cascade Health in Eugene, Oregon.

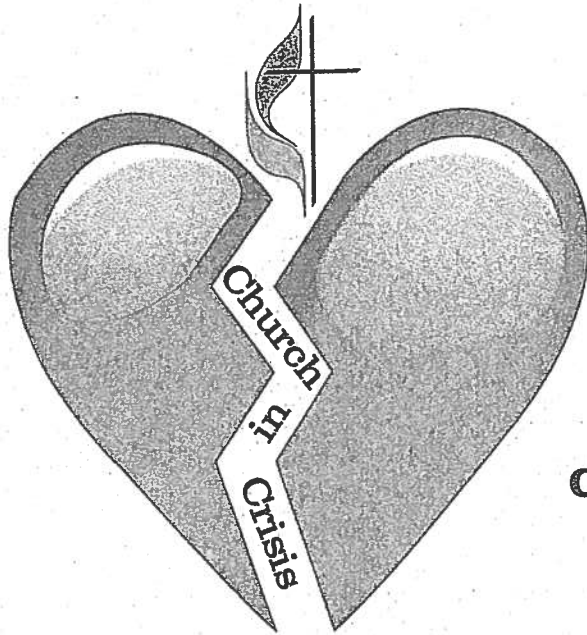

**How do we
faithfully live
out the love of
God in the face
of current issues?**

Nine class course starting

September 15

And continuing through

December 1

see the back of this sheet for schedule

Pre-registration required for meal service.
Childcare will be provided for those who need it.

Class format will be as follows:

- Dinner served at 5pm
- Presentations begin at 5:30 and run approximately 30 minutes
- Short centering worship will follow, 10-15 minutes
- Discussion groups will form and continue until 7pm

*(Class on Sept. 15 will have three presenters, and will extend until 7:30.
There will be no formal discussions that night.)*

*"Church in Crisis!" is an informational course about the difficult
choices facing United Methodists and their local Churches.*

We will be examining various topics, such as:

"How do we interpret Scripture?"

"What would 'schism' mean?"

"What are our options?"

For more information, contact Rich Keefe @ (208) 830.9166

How do we faithfully live out the love of God in the face of current issues?

Pre-registration required

- Sep 15 - Introduction / hearing experiences from UMC Pastors**
3 guest presenters sharing their stories
- Sep 22 - MANNA Potluck Fellowship (No Class)**
- Sep 29 - How do we interpret scripture?**
Review previous class and introduce the Quadrilateral
- Oct 6 - What the United Methodist Church Believes**
Discuss beliefs and also the structure/policies of the United Methodist Church
- Oct 13 - Fork-in-the-Road: Stay as we are**
A look at staying & accepting current rules versus stay and resist
- Oct 20 - Fork-in-the-Road: Schism Plans**
Look at some proposed plans for separating/splitting the United Methodist Church
- Oct 27 - MANNA Potluck Fellowship (No Class)**
- Nov 3 - What is our Christian Duty to Self and Church?**
Look at personal duty to the church on many levels
- Nov 10 - What is our Christian Duty to fellow humans?**
*Look at our duty to neighbors.
What does it mean to be welcoming?*
- Nov 17 - Where does our Episcopacy [Oregon-Idaho Conference] stand?**
What are we hearing from the Western Jurisdiction?
- Nov 24 - MANNA Potluck Fellowship (No Class)**
- Dec 1 - What's next?**
*Where do you stand?
Where does our congregation stand?
What do we do now?*

Nurturing Generous Living Thoughts about generosity from Discipleship Ministries of the United Methodist Church



Generosity is a matter of action, intentions, and heart. One way to describe it is the grateful outpouring of gifts to others, out of our love for God. *Outpouring* is a terrific description, since the priceless treasure of the gospel (and all the gifts of covenant, relationship, and life that go with it) comes from God and is meant to be poured out, through our living, upon others. Paul states this directly in 2 Corinthians 4:5-7, when he says, "We have this treasure in clay jars, so that it may be made clear that this extraordinary power belongs to God and does not come from us."

Whether for fancy purposes or everyday usage, the "unadorned pots of our daily lives" (as *The Message* puts it) highlight the fact that **all of who we are and what we have comes from God** and is to be used for God's purposes. God can use our uniqueness, even our limitations, weaknesses and eccentricities, to communicate God's powerful presence and love.

Generous living is not just about giving money, or even just about giving. It has to do with **the whole of who we are and how we care for our neighbors** (see Mark 12:28-31). Each of us brings our heart, mind, soul, and strength. The Old Testament word for "heart" is literally the leaning or thrust of our lives. We might call it our lifestyle or nonverbal witness. In other words, it is how we steward 100 percent of our lives, not just the "religious" sector or the percentage we give away.

So how do we lead stewardship in our local church? By nurturing generous living in our personal lives and in our life together as part of our congregation and Christ's interconnected, connectional church.

Nurturing generous living in every aspect of our life together before God -- now that's great stewardship.

THINGS HAPPENED AT SAWTOOTH FAMILY CAMP

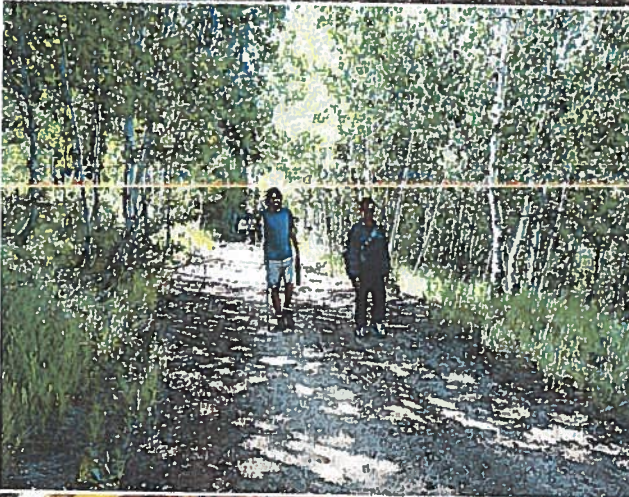
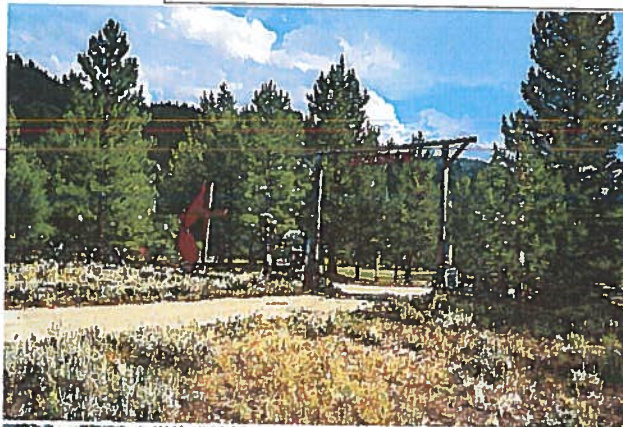



PHOTOS BY MARY KIENZLE



2019

Whitney United Methodist Church
Worship at 10:00 a.m. Sunday

Sunday	Monday	Tuesday	Wednesday	Thursday	Friday	Saturday
1 10:00 Worship 9:30 am Nursery Open 9:30 am Adult Sunday School 10:20 am Children's SS 12:00 pm Church Council	2 Labor Day	3 6:00 pm Scouts	4 12 noon UMW 2:00 pm Prayer & Share Small Group 7:00 pm Chancel Choir	5 10:00 am Visitors follow-up 5:45 pm Praise Band	6	7 10:00 am Saturday lunch
8 10:00 Worship 9:30 am Nursery Open 8:30 am "Practical Scripture" with Shelley 9:30 am Adult Sunday School 10:20 am Children's SS	9 9:30 am Finance 6:30 pm Shawlwers	10 6:00 pm Scouts	11 1:30 pm Prayer & Share Small Group 7:00 pm Chancel Choir	12 5:45 pm Praise Band	13	14 9:00 am UMM 10:00 am Saturday lunch
15 10:00 Worship 9:30 am Nursery Open 8:30 am "Practical Scripture" with Shelley 9:30 am Adult SS 10:20 am Children's SS 5:00 pm "Church in Crisis"	16 10:00 am Congregational Care 6:30 pm Stephen Ministry	17 6:00 pm Scouts 7:00 Celia Cowan @ Carol Adams'	18 1:30 pm Prayer & Share Small Group 7:00 pm Chancel Choir	19 5:45 pm Praise Band	20 6:00 pm Community Dinner	21 10:00 am Saturday lunch 2-4 pm Mikki
22 10:00 Worship 9:30 am Nursery Open 8:30 am "Practical Scripture" with Shelley 9:30 am Adult SS 10:20 am Children's SS 11:15 am Coffee with Pastor 5:00 pm MANNA	23 6:30 pm Shawlwers	24 6:00 pm Scouts	25 1:30 pm Prayer & Share Small Group 7:00 pm Chancel Choir	26 5:45 pm Praise Band	27	28 10:00 am Saturday lunch Sage District UMW @ Kimberly 1-6 pm AA
29 10:00 Worship 9:30 am Nursery Open 8:30 am "Practical Scripture" with Shelley 9:30 am Adult SS 10:20 am Children's SS 5:00 pm "Church in Crisis"	30					